

# Hi Tech Systems Ltd

## Product overview

**INNOVATIVE DEVELOPER AND MANUFACTURER OF BROADCAST PRODUCTION,  
PLAY-OUT CONTROL SYSTEMS**

OCTOBER 2025

# Hi Tech Systems overview

Hi Tech Systems is a UK based manufacturer of control systems for the broadcast television industry and has been designing and building control systems since the 1990s. The company was established by its founder and managing director Tom Favell who continues to lead the organisation which is based in Hampshire.

Target customers are TV broadcasters, service providers, and cable and satellite operators. Products are operator focused and designed to be flexible, reliable and scalable. A range of control systems are available from simple 1 or 2 channel control to facility wide solutions. The company's innovative solutions manage ingest and multi-channel playout workflows around the world.



# Solution Types

Sophisticated control



Avita: Software applications that run on Array control panels

Configurable panels



Array: Configurable hardware control panels for Avita

Simple control



- Basic control panel for 1 or 2 video server channels
- VTR control from 1 to 8 channels

# Hi Tech Systems Technology



Avita is a system of software applications encompassing ingest, play out, scheduling, News & Sports and works with any professional video server. Array control panels can be fully integrated into an Avita system.

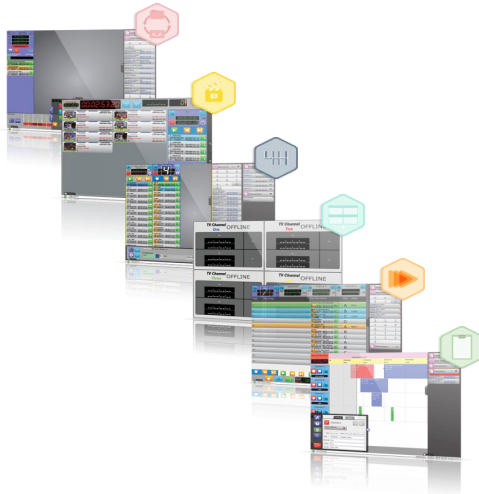

Array is a range of control panels that can be combined together to form a control surface to suit a multitude of workflows. Works with Avita software.



The Altus HT252 and HT262 hardware control panels feature compact control of two server ports with clip management tools to make the most of a server's record and replay capabilities. Operators no longer have to rely on a front panel user interface to select, load and play clips in a live environment – which can be fraught with disaster



# Avita deployment overview

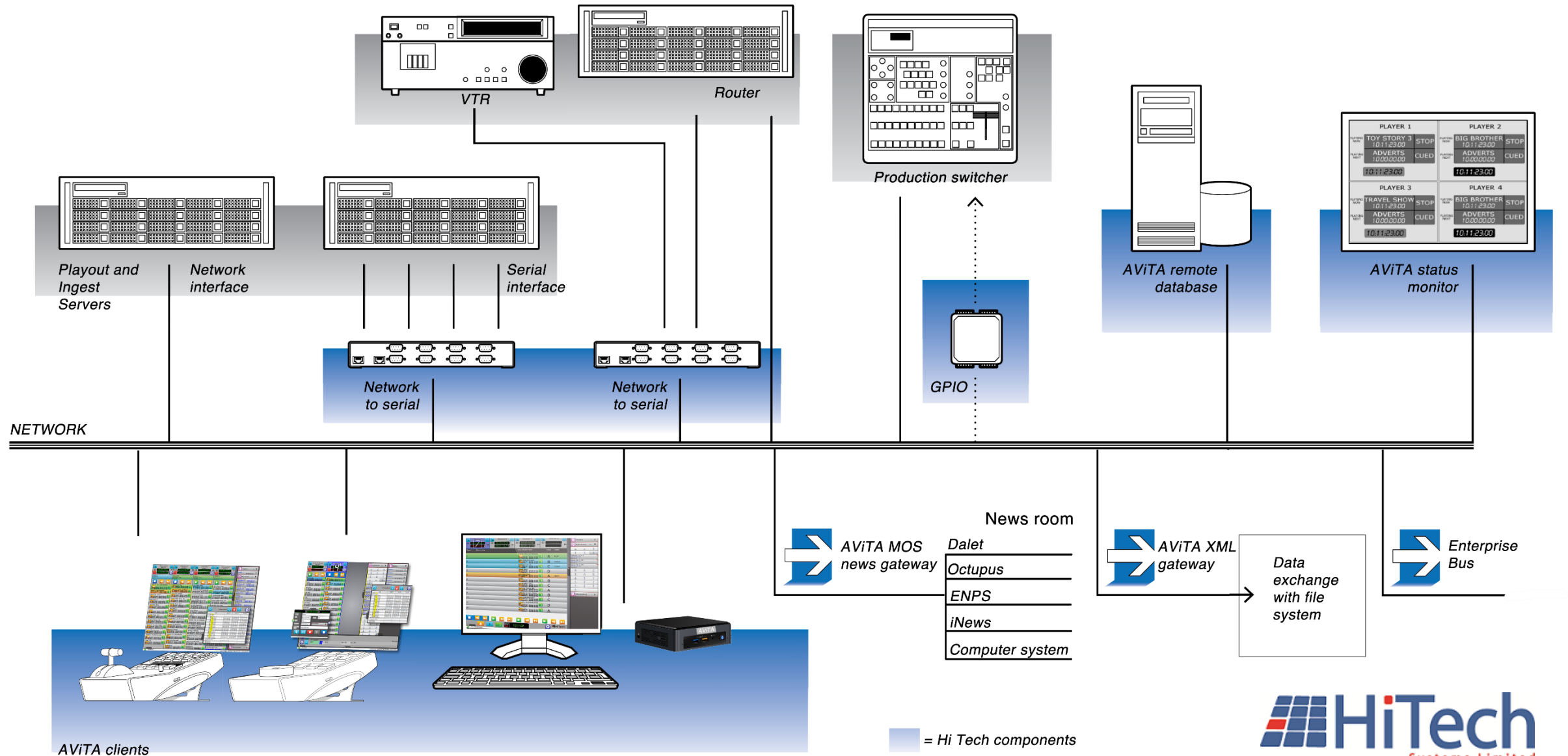



# Array Control Panel Details

## OLED KEYS

Well spaced OLED keys with user assignable graphics and text and programmable with RGB illuminations.

## OPTIONAL WHEEL OR T-BAR

Weighted wheel with padded centre grip - programmable for jog, shuttle and variable playback functions.  
T-bar for smooth slo-mo playback, programmable for speed range and resolution.

## OPTIONAL STATUS DISPLAY

High resolution OLED display for timecode, channel selection, system information.

## RGB KEYS

Well spaced, tactile and programmable RGB keys.

## OPTIONAL WHEEL OR T-BAR

Weighted wheel with padded centre grip - programmable for jog, shuttle and variable playback functions.  
T-bar for smooth slo-mo playback, programmable for speed range and resolution.

## OPTIONAL STATUS DISPLAY

High resolution OLED display for timecode, channel selection, system information.

## BUTTON FUNCTION DISPLAY

Crystal clear OLED display with user assignable graphics and text.

## MULTI-DIRECTIONAL WHEEL

6 way multi directional wheel. User programmable for multiple functions.

## DATA BUS

Recessed connector for power and data transfer between Array surfaces using the supplied data bus connector card.

## CONTEMPORARY DESIGN

Case is made from steel with machined aluminium side panels and display bezel with a highly durable finish. Ergonomic design with tapered sides.

## CONNECTOR POD

Cable interface for DC power input socket, bi-directional USB and RJ45 network connectors. Only one required for an Array system.

## SOFT PUSH ON / OFF SWITCH

## POWER ON INDICATOR

## REAR STAND

Cable slot for strain relief and cable retainer with rubber non-slip base.

## UNDER CASE ILLUMINATION

**MAGNETIC LOCK**  
Hidden magnets hold Array surfaces together.



# Hi Tech Systems 2025

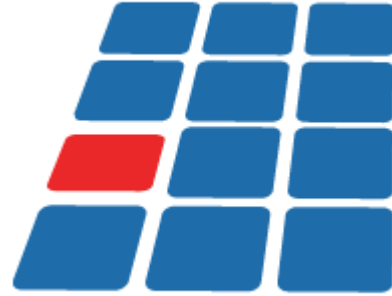

Visit [www.hitechsys.com](http://www.hitechsys.com)

***We take the technical complexity from the operator and put it in the back room***